

What are the top three things most important to you to see as part of the provision of a replacement car park at Milton Road?



Are there any problems or concerns in Dovercourt that are caused by the two Victoria Street sites being empty?



What are the top three things most important to you to see improved as part of new homes being provided on Victoria Street?



Any other thoughts or ideas?

Add a few trees

Opportunity to provide housing for local people in need

Give residents adequate parking

Build legacy of youth engagement

Renew street signs and provide better lighting

How safe do you feel on and around the site as it is today?

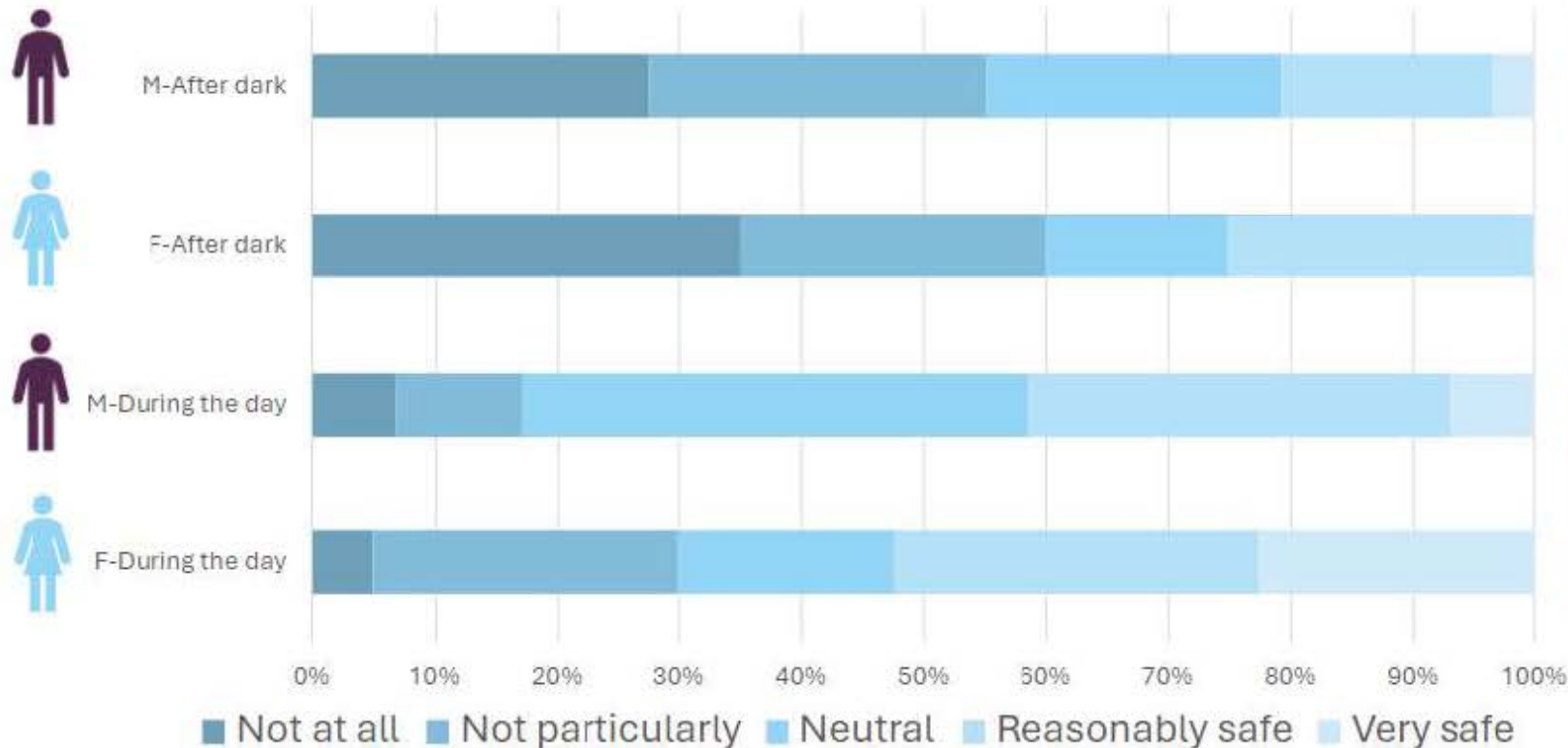

60% of females and 55% of males felt unsafe during hours of darkness

Females reported feeling unsafe because of anti-social behaviour, poor lighting, and access

What is most important to you to see improved on the site?



Of the three site layout options, which do you prefer?

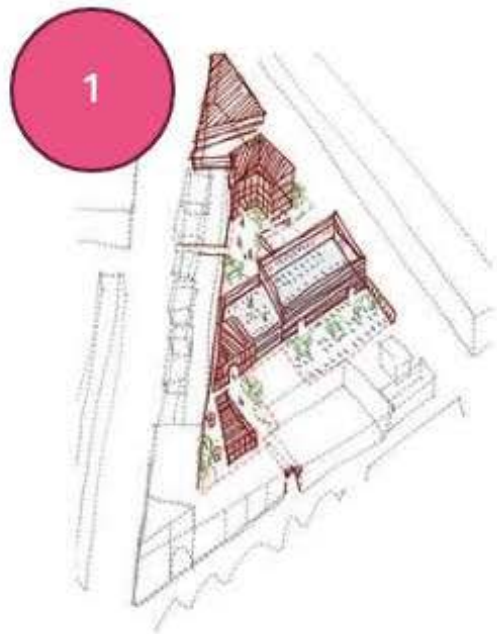

Clear zones



Fills in site corners and takes car park away from road

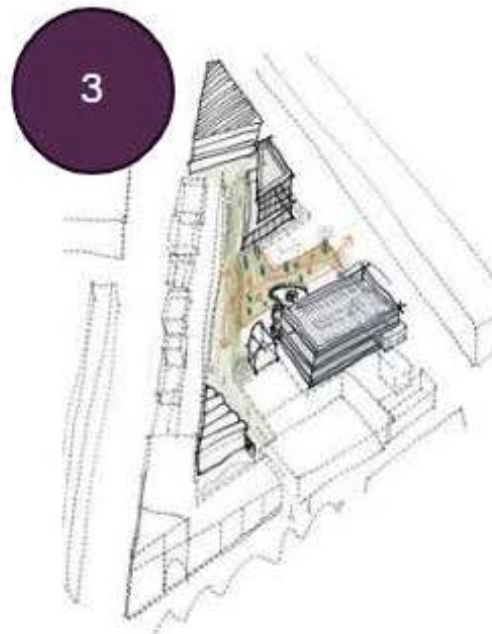

More public open space

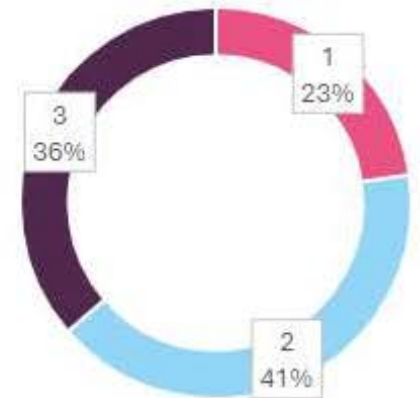

What kind of open space, greenery and green spaces would you like to see?

