

How safe do you feel on and around the site as it is today?

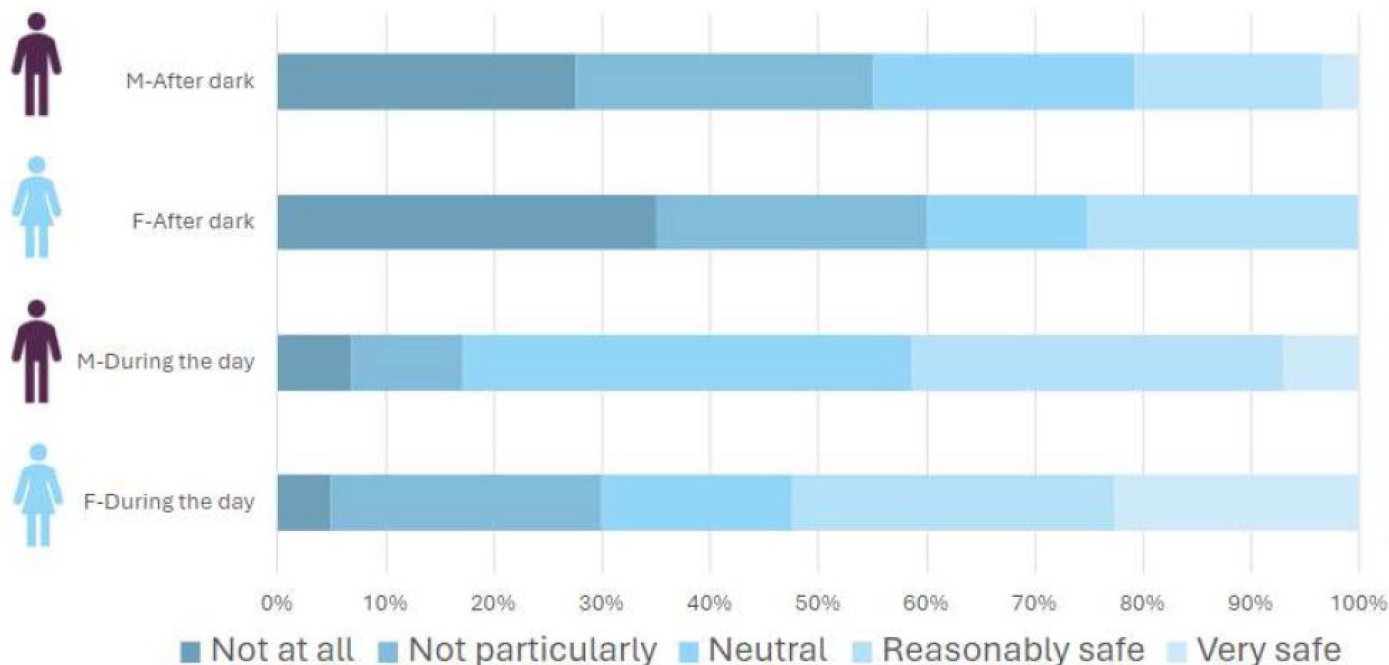

60% of females and 55% of males felt unsafe during hours of darkness

Females reported feeling unsafe because of anti-social behaviour, poor lighting, and access

What is most important to you to see improved on the site?



Of the three site layout options, which do you prefer?

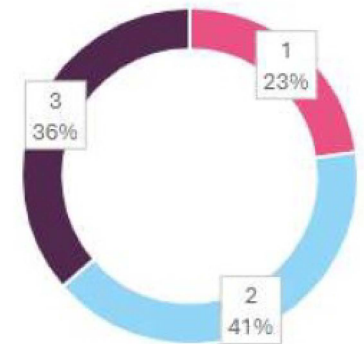
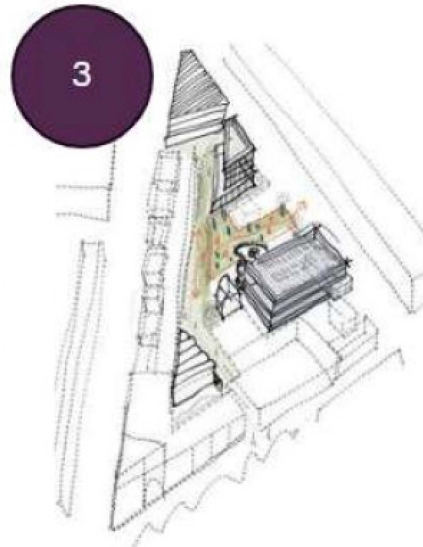
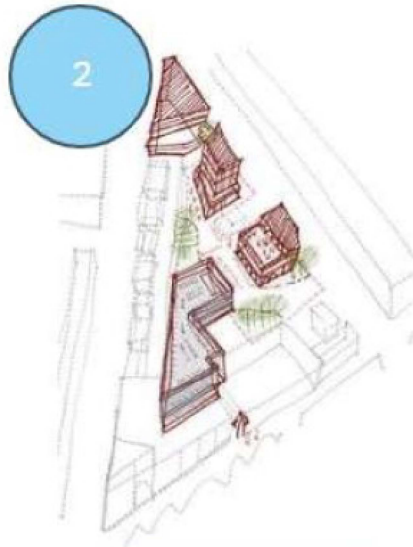
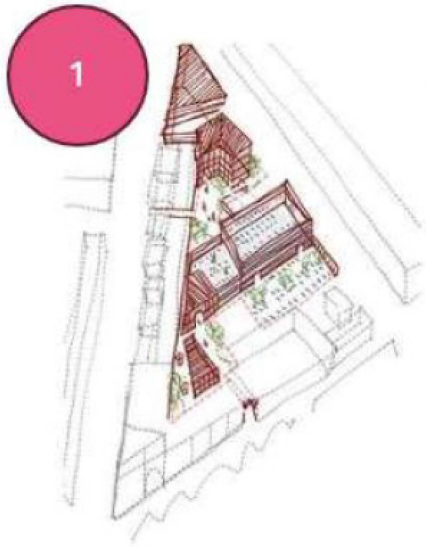

Clear zones

Fills in site corners and takes car park away from road

More public open space

What kind of open space, greenery and green spaces would you like to see?

